



## **Installation Sheet K6855714** **RT Seat Belt Installation**

### ***Lap/Shoulder Belt Operating Instructions***

Enter the vehicle and close the door. Sit back and adjust the seat. The seat belt latch plate is above the back of the front seat, and next to your arm in the rear seat (for vehicles equipped with a rear seat). Grasp the latch plate and pull out the seat belt. Slide the latch plate up the webbing as far as necessary to allow the seat belt to go around your lap. When the seat belt is long enough to fit, insert the latch plate into the buckle until you hear a “click.” Position the lap belt so that it is snug and lies low across your hips, below your abdomen. To remove slack in the lap belt portion, pull up on the shoulder belt. To loosen the lap belt if it is too tight, tilt the latch plate and pull on the lap belt. A snug seat belt reduces the risk of sliding under the seat belt in a collision. Position the shoulder belt across the shoulder and chest with minimal, if any slack so that it is comfortable and not resting on your neck. The retractor will withdraw any slack in the shoulder belt. To release the seat belt, push the red button on the buckle. The seat belt will automatically retract to its stowed position. If necessary, slide the latch plate down the webbing to allow the seat belt to retract fully.

If a seat belt is not long enough to fit properly, even when the webbing is fully extended and the adjustable upper shoulder belt anchorage (if equipped) is in its lowest position, your authorized dealer can provide you with a Seat Belt Extender. The Seat Belt Extender should be used only if the existing seat belt is not long enough. When the Seat Belt Extender is not required for a different occupant, it must be removed.

### **WARNING!**

- ONLY use a Seat Belt Extender if it is physically required in order to properly fit the original seat belt system. DO NOT USE the Seat Belt Extender if, when worn, the distance between the front edge of the Seat Belt Extender buckle and the center of the occupant’s body is LESS than 6 inches.
- Using a Seat Belt Extender when not needed can increase the risk of serious injury or death in a collision. Only use the Seat Belt Extender when the lap belt is not long enough and only use in the recommended seating positions. Remove and store the Seat Belt Extender when not needed.

### ***Seat Belts And Pregnant Women***

Seat belts must be worn by all occupants including pregnant women: the risk of injury in the event of an accident is reduced for the mother and the unborn child if they are wearing a seat belt. Position the lap belt snug and low below the abdomen and across the strong bones of the hips. Place the shoulder belt across the chest and away from the neck. Never place the shoulder belt behind the back or under the arm.

**WARNING: To avoid serious or fatal injury on vehicles equipped with airbags, disable the Supplemental Restraint System (SRS) before attempting any steering wheel, steering column, airbag, Occupant Classification System (OCS), seat belt tensioner, impact sensor or instrument panel component diagnosis or service. Disconnect and isolate the battery negative (ground) cable, then wait two minutes for the system capacitor to discharge before performing further diagnosis or service. This is the only sure way to disable the SRS. Failure to follow these instructions may result in accidental airbag deployment.**

**WARNING: To avoid serious or fatal injury during and following any seat belt or child restraint anchor service, carefully inspect all seat belts, buckles, mounting hardware, retractors, tether straps, and anchors for proper installation, operation, or damage. Replace any belt that is cut, frayed, or torn. Straighten any belt that is twisted. Tighten any loose fasteners. Replace any belt that has a damaged or ineffective buckle or retractor. Replace any belt that has a bent or damaged latch plate or anchor plate. Replace any child restraint anchor or the unit to which the anchor is integral that has been bent or damaged. Never attempt to repair a seat belt or child restraint component. Always replace damaged or ineffective seat belt**



and child restraint components with the correct, new and unused replacement parts listed in the Chrysler Mopar® Parts Catalog. Failure to follow these instructions may result in possible serious or fatal injury.

**WARNING:** To avoid serious or fatal injury on vehicles equipped with the Occupant Classification System (OCS), do not modify the front passenger seat assembly or center floor console in any way. Do not use any prior year, subsequent year, secondary or aftermarket seat trim covers. At no time should any Supplemental Restraint System (SRS) or OCS component be modified or replaced with any part except those which are specified for the particular vehicle application in the Chrysler Mopar® Parts Catalog. Failure to observe these precautions could cause an OCS miscalibration condition, which may result in the passenger airbag failing to deploy when required or deploying when not required.

**WARNING:** To avoid serious or fatal injury, never strike or drop a seat weight sensor or the passenger side front seat assembly to which the sensors are secured as it can damage the sensors or affect their calibration. The seat weight sensors and the passenger side front seat assembly must be handled with care to avoid damage to the sensors. Do not sit upon or place any loads upon a passenger side front seat while it is removed from its mounts in or outside of the vehicle. If an individual sensor is dropped or damaged, replace the sensor with a new and unused unit. If a seat has been dropped during removal or loaded while removed from its mounts, replace each of the seat weight sensors with new and unused units. Failure to observe this warning could result in an accidental, incomplete, or improper passenger side front Supplemental Restraint System (SRS) component deployment.

**WARNING:** To avoid serious or fatal injury on vehicles equipped with the Occupant Classification System (OCS), any time the passenger side front seat assembly has been removed or loosened from the vehicle for service of any vehicle component or system the Occupant Classification System (OCS) Verification Test must be performed using a diagnostic scan tool and the Occupant Classification Seat Weight special tool following reinstallation. Refer to the appropriate diagnostic procedures. Failure to observe this warning could result in an accidental, incomplete, or improper passenger side front Supplemental Restraint System (SRS) component deployment.

## FRONT SEAT DOMESTIC

1. Position the front seat belt buckle (1) lower anchor to the bracket (5) at the back of the inboard seat track (Figure 1).
2. Install and tighten the screw (4) that secures the lower anchor to the seat track bracket. Tighten the screw to 39 Nm (29 ft lb) (Figure 1).
3. For the driver side front seat belt buckle only, reconnect the seat belt switch pigtail wire (3) connector to the seat wire harness connector (Figure 1).
4. Reinstall the side shield onto the inboard side of the front seat cushion (2) (Figure 1).

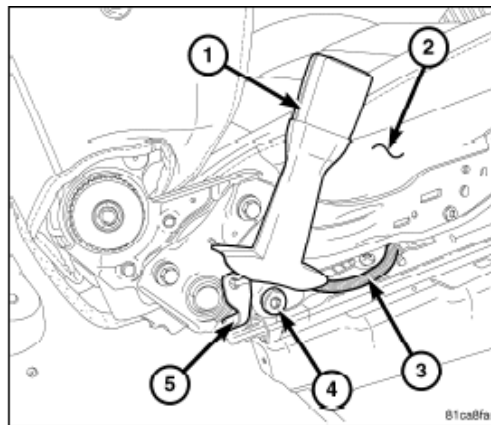
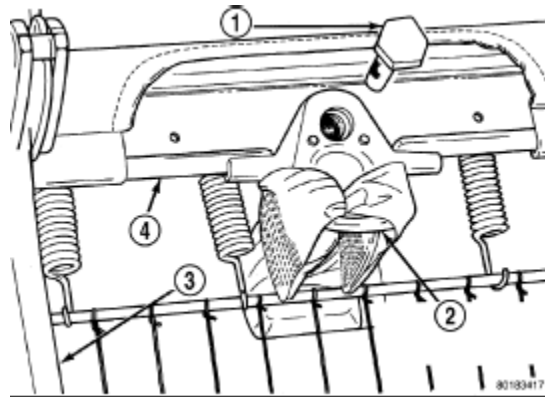

Figure 1

## SECOND ROW BENCH SEAT

1. Position the double seat belt buckle lower anchor (2) to the rear edge of the cushion frame (4) on the underside of the bench seat (Figure 2).
2. Install and tighten the screw (1) that secures the double buckle unit to the seat. Tighten the screw to 39Nm (29 ft lb) (Figure 2).
3. Reinstall the second row bench seat into the vehicle.



**Figure 2**

## SECOND ROW BUCKET SEAT EXCEPT SWIVEL

1. Carefully pull the base of the inboard seat back hinge (1) away from the inboard side of the seat cushion frame (3) far enough to position the seat belt buckle lower anchor (2) between the frame and the hinge (Figure 3).

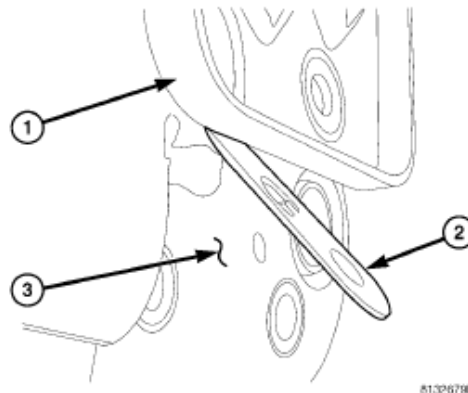

**Figure 3**

2. Install and tighten the screws (4) that secure the hinge (2) to the seat cushion. Tighten the screws to 39 Nm (29 ft lb).
3. Reinstall the hinge cover and the side shield to the inboard side of the seat.

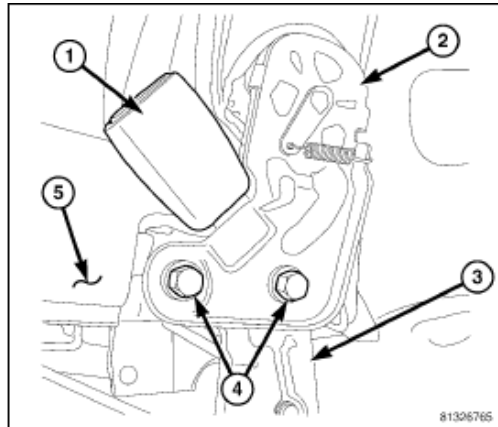

**Figure 4**

### **SECOND ROW BUCKET SEAT SWIVEL**

1. Position the seat belt buckle (1) lower anchor to the inboard seat back hinge bracket (2). Ensure engagement of anti-rotation tab of the lower anchor with the clearance hole of the hinge bracket (Figure 5).
2. Install and tighten the screws (3) that secure the buckle lower anchor to the hinge bracket. Tighten the screws to 39 Nm (29 ft lb) (Figure 5).
3. Reinstall the side shield and hinge cover to the inboard side of the seat cushion (4) (Figure 5).

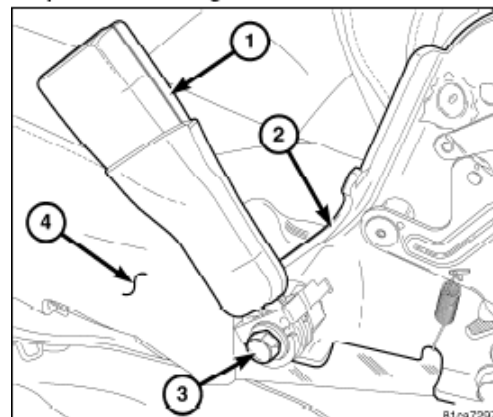
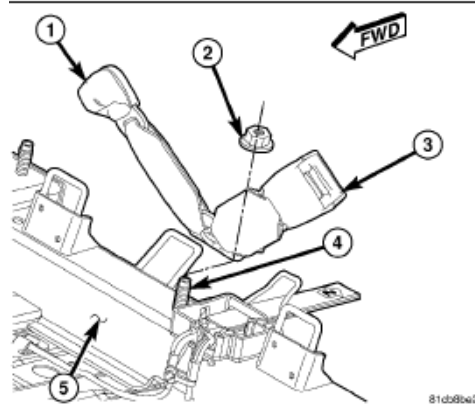

**Figure 5**

### **THIRD ROW BENCH DOUBLE BUCKLE**

1. From in front of the 60 percent third row seat back, insert the shared lower anchor of the third row center anchor buckle (1) and the left outboard seat belt buckle (3) through the clearance hole in the seat cushion trim cover to the back of the third row seat cushion frame (5) (Figure 6).
2. From the behind the seat back, engage the double buckle unit lower anchor over the stud (4) on the cushion frame (Figure 6).
3. Install and tighten the nut (2) that secures the double buckle lower anchor to the stud. Tighten the nut to 39 Nm (29 ft lb) (Figure 6).
4. Engage the J-clip retainers that secure the seat cushion trim cover to the rear edge of the seat cushion frame.

5. Reinstall the ends of the plastic grocery bag retainer onto the seat hinge cover at each side of the seat cushion.
6. Install and tighten the screws that secure the grocery bag retainer to the underside of the rear edge of the seat cushion frame.



**Figure 6**

### **THIRD ROW BENCH SINGLE BUCKLE**

1. Pull the forward edge of the trim cover (2) away from the side of the seat cushion (4) far enough to access the mounting stud on the seat cushion frame for the single third row seat belt buckle (1) lower anchor (Figure 7).
2. Position the buckle lower anchor onto the stud.
3. Install and tighten the nut (3) that secures the buckle lower anchor to the stud. Tighten the nut to 39 Nm (29 ft lb) (Figure 7).

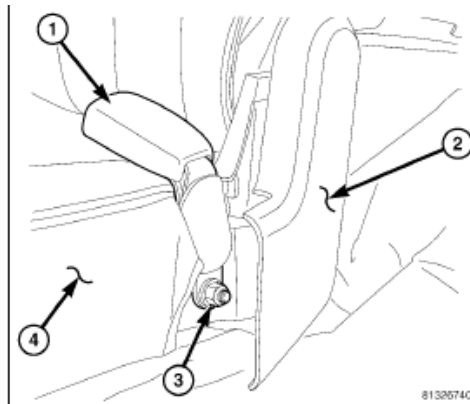

**Figure 7**

4. Position the trim cover (2) over the single third row seat belt buckle (1) lower anchor on the side of the seat cushion (4) (Figure 8).
5. Install and tighten the screw (3) that secures the trim cover to the seat cushion. Tighten the screw securely (Figure 8).
6. Restore to the seating position the seat section which did not have the buckle replaced.

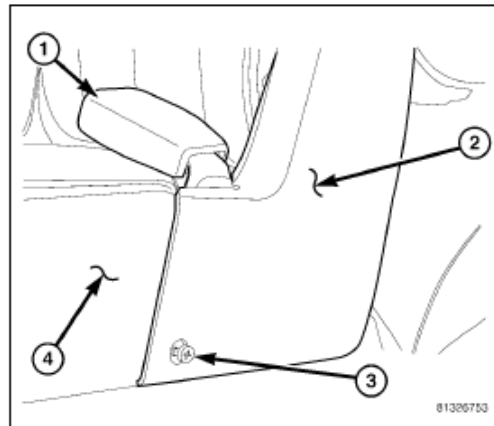
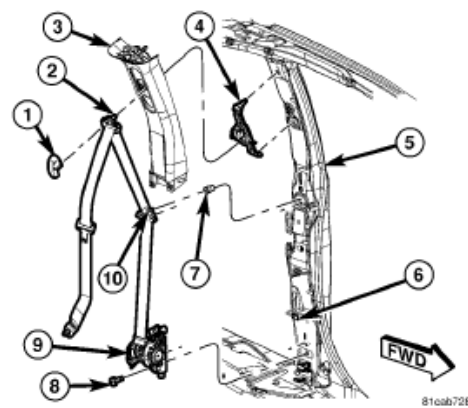

**Figure 8**

## Retractor Installation

### FRONT

1. Position the front seat belt and retractor (9) to the lower B pillar (5) as a unit. Ensure engagement of tab on the upper retractor bracket into the engagement slot in the lower B pillar (Figure 9).
2. Install and tighten the screw (8) that secures the lower retractor bracket to the B pillar. Tighten the screw to 39 Nm (29 ft lb) (Figure 9).
3. Reconnect the body wire harness connector (6) to the seat belt tensioner initiator on the retractor (Figure 9).
4. For export market vehicles on the driver side only, reconnect the second body wire harness connector to the seat belt switch connector receptacle on the retractor.
5. Position the belt web guide to the B pillar.
6. Install and tighten the screw (10) that secures the belt web guide to the B pillar. Tighten the screw to 9 Nm (79 in lb) (Figure 9).



**Figure 9**

7. Reinstall the lower trim onto the inside of the B pillar.
8. Reinstall the upper trim (3) onto the inside of the B pillar (Figure 9).
9. Position the seat belt turning loop onto the height adjuster (4) on the upper B pillar (Figure 9).

10. Install and tighten the screw (2) that secures the turning loop to the height adjuster. Tighten the screw to 39 Nm (29 ft lb) (Figure 9).
11. Snap a new trim cover (1) onto the height adjuster (4) on the upper B pillar (Figure 9).
12. Position the front seat belt (3) lower anchor to the bracket on the outboard side of the front seat cushion frame (Figure 10).
13. Install and tighten the screw (2) that secures the lower anchor to the bracket on the outboard side of the front seat cushion frame. Tighten the screw to 39 Nm (29 ft lb) (Figure 10).

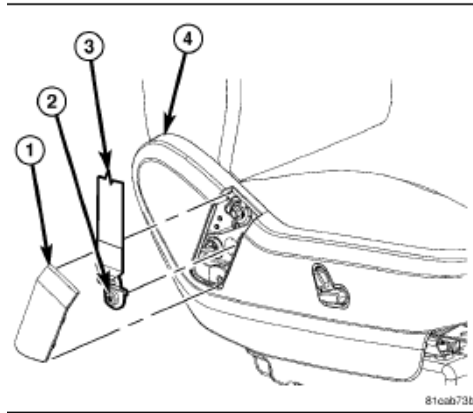

**Figure 10**

14. Install the seat belt (2) through the insert (3) and position the insert to the opening near the rear of the outboard seat side shield (1) (Figure 11).
15. Engage the retaining tabs that secure the insert to the side shield by sliding the insert straight down. Ensure that the retaining tabs are fully engaged with the side shield.
16. Do not reconnect the battery negative cable at this time. The Supplemental Restraint System (SRS) verification test procedure should be performed following service of any SRS component.

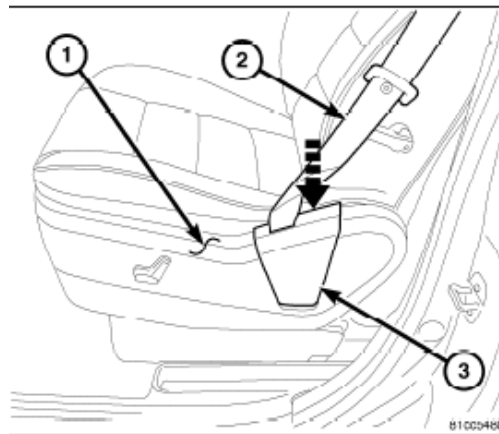

**Figure 11**

## **SECOND ROW EXCEPT**

### **SWIVEL**

1. On the right side only if removed, position the lower seat belt anchor bracket (8) onto the floor panel (7) near the base of the C pillar (10) (Figure 12).





2. On the right side only if removed, install and tighten the screw (9) that secures the anchor bracket to the floor panel. Tighten the screw to 39 Nm (29 ft lb) (Figure 12).
3. Position the second row outboard seat belt and retractor (5) to the C pillar as a unit (Figure 12).
4. Engage the tab on the retractor bracket into the keyed slot in the C pillar.
5. Install and tighten the screw (6) that secures the retractor to the lower C pillar. Tighten the screw to 39 Nm (29 ft lb) (Figure 12).
6. Reinstall the upper trim (1) onto the inside of the C pillar (Figure 12).
7. Position the second row seat belt turning loop onto the height adjuster (2) on the upper C pillar (Figure 12).

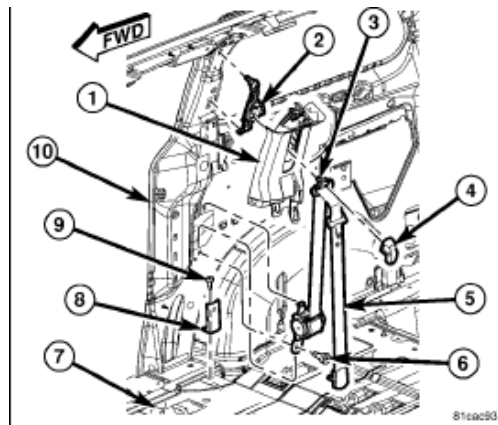

**Figure 12**

8. Install and tighten the screw (3) that secures the turning loop to the height adjuster. Tighten the screw to 39 Nm (29 ft lb) (Figure 12).
9. Snap a new trim cover (4) onto the height adjuster on the upper C pillar (Figure 12).
10. Reinstall the trim panel (2) onto the quarter inner panel (Figure 13).
11. Position the seat belt and retractor (5) lower anchor to the anchor bracket (4) on the floor panel (right side only) or directly to the floor panel (left side only) near the base of the C pillar (1).
12. Install and tighten the screw (3) that secures the seat belt lower anchor to the anchor bracket or to the floor. Tighten the screw to 39 Nm (29 ft lb) (Figure 13).

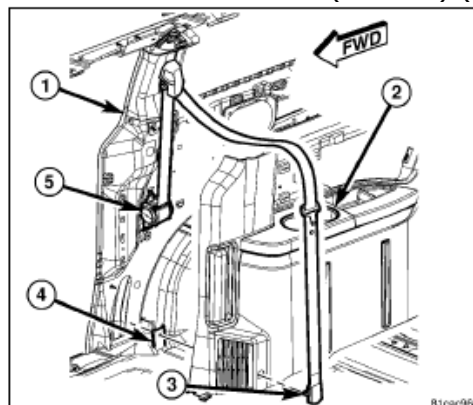

**Figure 13**





## SECOND ROW SWIVEL

1. Position the second row swivel seat belt and retractor to the upper outboard seat back frame (1) as a unit (Figure 14).
2. Engage the retractor tab (2) into the keyed slot on the back of the upper outboard corner of the seat back frame (Figure 14).
3. Install and tighten the screw (3) that secures the seat belt retractor to the seat back frame. Tighten the screw to 39 Nm (29 ft lb) (Figure 14).

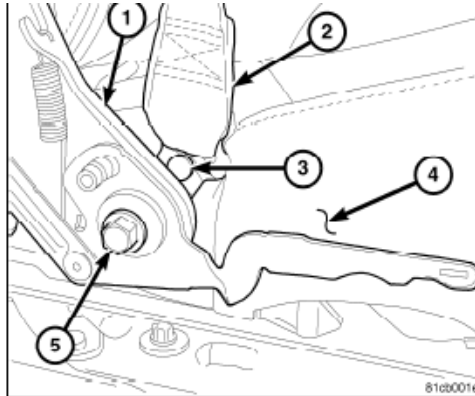

**Figure 14**

4. Ensure that seat belt webbing is routed between the back of the retractor cavity in the seat back frame (3) and the cross bolt above the retractor within the cavity that serves as the belt webbing pivot spool (Figure 15).
5. Position the retractor shield (1) over the seat belt retractor on the front of the upper outboard corner of the seat back frame. Ensure that the seat belt webbing is not twisted between the retractor and the shield and that the latch plate (4) is on the outside of the shield (Figure 15).
6. Install and tighten the two screws (2) that secure the shield to the seat back frame. Tighten the screws securely (Figure 15).
7. Reinstall the seat back cushion and trim cover onto the seat back frame (3) (Figure 15).

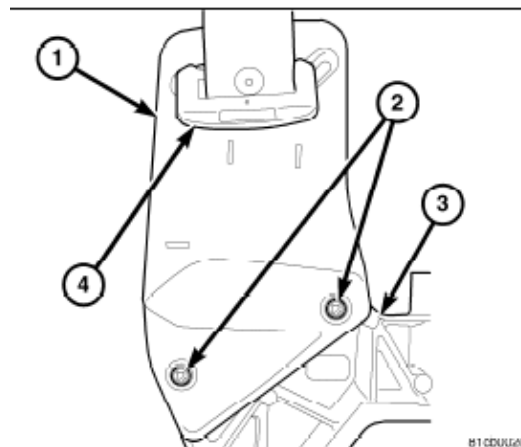

**Figure 15**

8. Position the seat belt (2) lower anchor to the outboard side of the seat cushion (4). Ensure that the belt webbing is not twisted between the top of the seat back and the side of the seat cushion (Figure 16).
9. Engage the push in plastic fastener (3) that secures the seat belt lower anchor to the outboard side of the seat cushion frame (Figure 16).
10. Reinstall the seat back and seat back hinges (1) to the seat cushion as a unit. Ensure that the forward outboard hinge bracket screw engages the lower seat belt anchor. Tighten the seat belt lower anchor screw (5) to 39 Nm (29 ft lb) (Figure 16).
11. Reinstall the second row swivel seat unit into the vehicle.

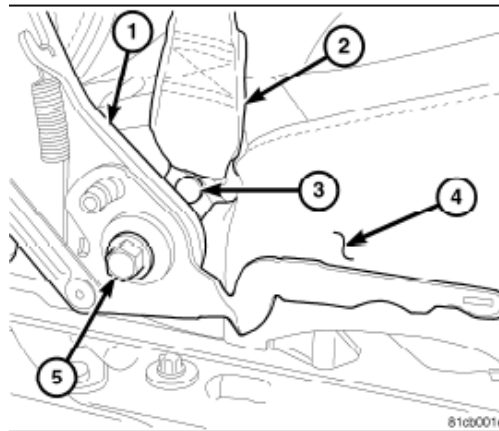

**Figure 16**

### **THIRD ROW CENTER**

1. Position the third row center seat belt and retractor (2) to the two studs (1) on the inside of the rear header (3) near the lift gate opening as a unit (Figure 17).
2. Engage the two plastic push in retainers that secure the retractor bracket to the inside of the rear header.
3. Install and tighten the two nuts (4) that secure the retractor bracket to the inside of the rear header. Tighten the nuts to 39 Nm (29 ft lb) (Figure 17).
4. Position the third row center seat belt turning loop (6) onto the stud (7) on the inside of the rear header near the lift gate opening. Ensure that the belt webbing between the retractor and the turning loop is not twisted (Figure 17).
5. Install and tighten the nut (5) that secures the turning loop to the inside of the rear header. Tighten the nut to 39 Nm (29 ft lb) (Figure 17).

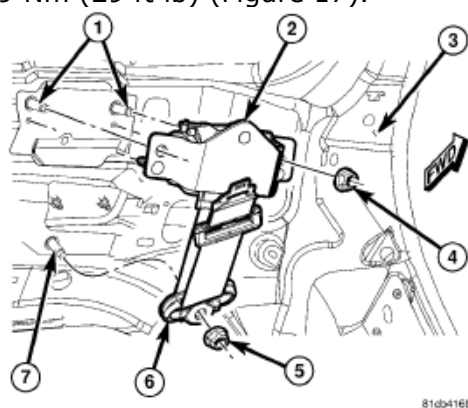

**Figure 17**

6. Route the seat belt (5) and both latch plates (3 and 4) through the clearance hole in the lift gate opening trim molding (2) (Figure 18).
7. Reinstall the trim molding onto the upper lift gate opening header (1) (Figure 18).
8. Engage the third row center seat belt latch plate and lower anchor latch plate with their respective storage provisions in the trim molding on the upper lift gate opening header.

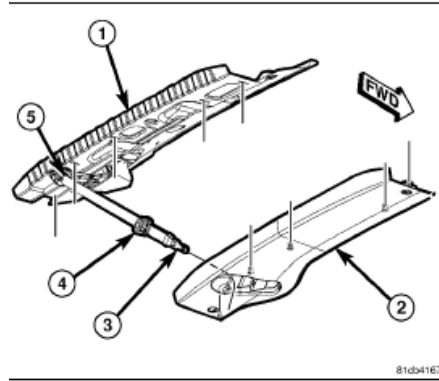

**Figure 18**

### THIRD ROW OUTBOARD

1. Position the third row outboard seat belt and retractor unit (3) to the quarter inner panel (1) as a unit (Figure 19).
2. Engage the tab on the retractor bracket into the keyed slot in the quarter inner panel.
3. Install and tighten the screw (4) that secures the retractor bracket to the quarter inner panel. Tighten the screw to 39 Nm (29 ft lb) (Figure 19).
4. Engage the clips that secure the seat belt web guide (2) to the quarter inner panel. Ensure that the belt webbing is not twisted between the retractor and the web guide (Figure 19).

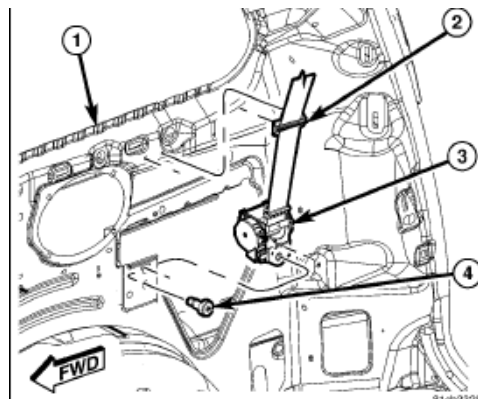

**Figure 19**

5. Engage the tab on the seat belt turning loop bracket (2) into the keyed slot in the inner roof rail (1). Ensure that the belt webbing is not twisted between the web guide and the turning loop (Figure 20).
6. Install and tighten the screw that secures the turning loop bracket to the inner roof rail. Tighten the screw to 39 Nm (29 ft lb).

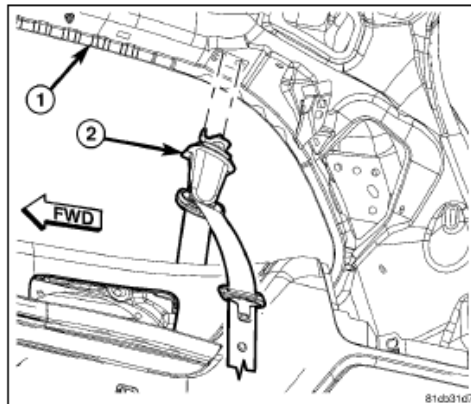

**Figure 20**

7. Push the turning loop bracket cover (3) up to the headliner (Figure 21).
8. Reinstall the quarter trim panel (5) to the quarter inner panel (Figure 21).
9. Reinstall the quarter trim bolster (2) to the quarter trim panel (Figure 21).
10. Position the seat belt lower anchor (4) to the stud on the quarter inner panel. Ensure that the belt webbing (1) is not twisted between the turning loop and the lower anchor (Figure 21).
11. Install and tighten the nut that secures the lower anchor to the stud on the quarter inner panel. Tighten the nut to 39 Nm (29 ft lb).
12. Restore the third row seat to its seating position.

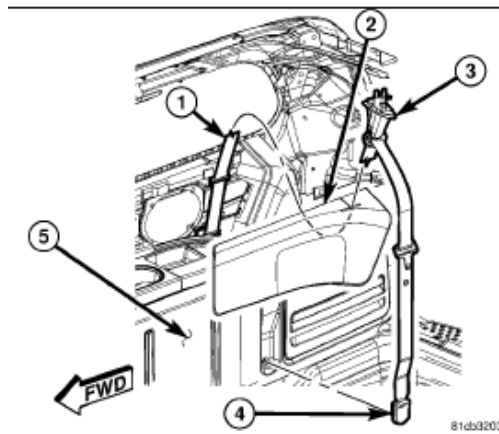

**Figure 21**