

2.4L ENGINE

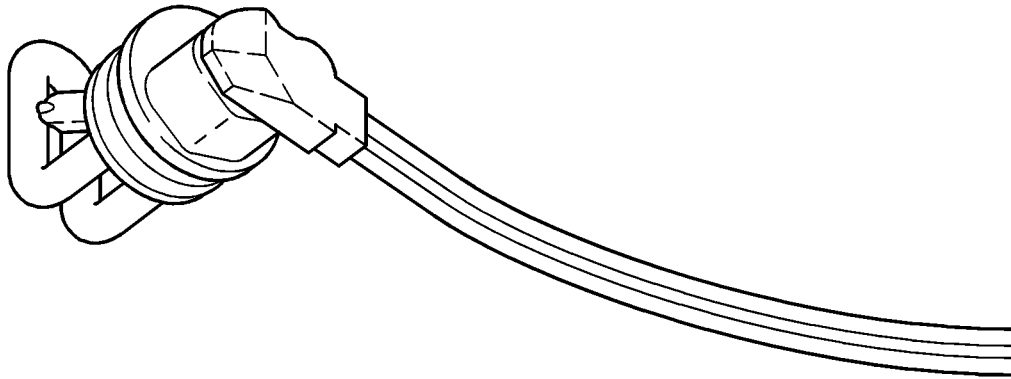

3.7L ENGINE

INSTALLATION INSTRUCTION **ENGINE BLOCK HEATER**

Subject to alteration without notice

Expert Fitment Required

03-20-2001 K6858453

© DAIMLERCHRYSLER

KIT CONTENTS FOR VEHICLES EQUIPPED WITH 2.4L ENGINES. REFER TO PAGES 2-4.

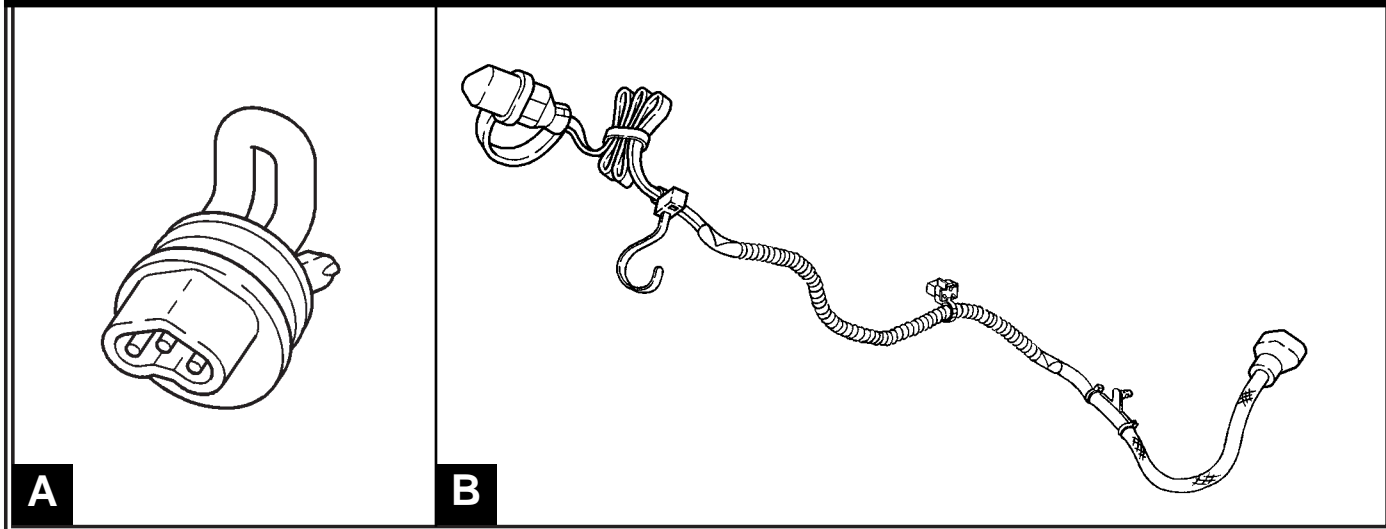

KIT CONTENTS FOR VEHICLES EQUIPPED WITH 3.7L ENGINES. REFER TO PAGES 2, 5-6.

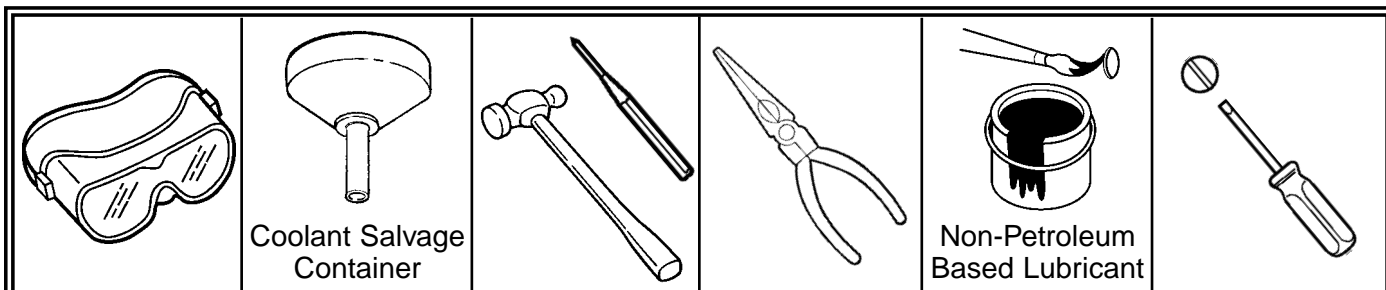
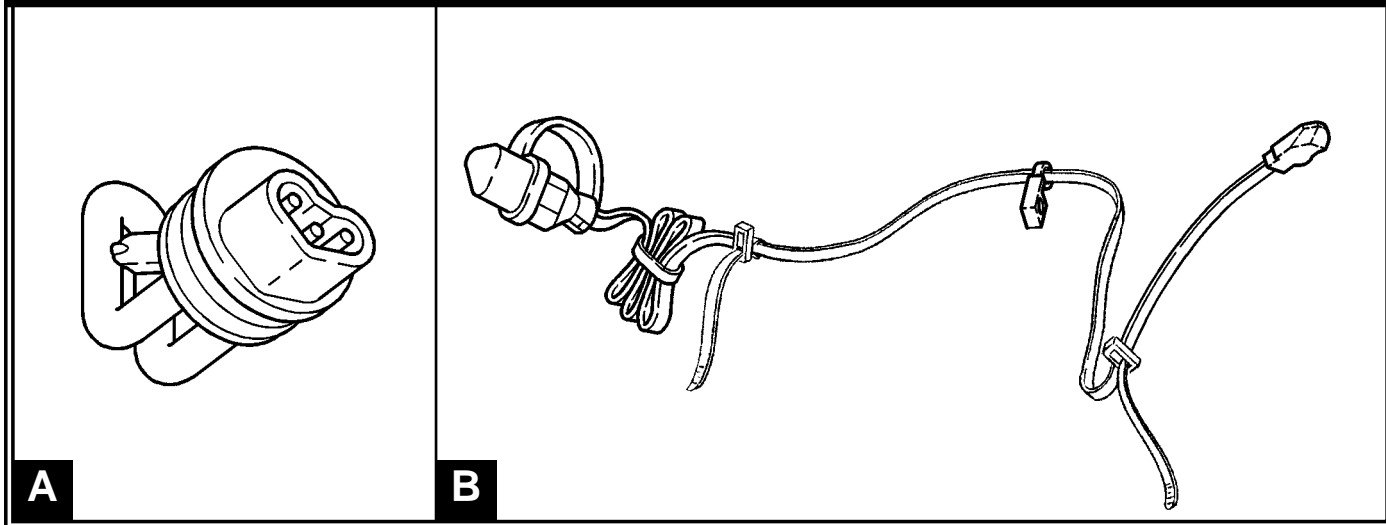

APPLICATION: JEEP LIBERTY (KJ)

CAUTION! Before connecting the block heater/cordset to a power source, be sure that the element is immersed in coolant. NEVER energize heater in the open air. The element sheath could burst.

■ Drain coolant from the radiator and cylinder block and save for re-use. Refer to cooling system draining procedure in the service manual.

CAUTION! Make sure that vehicle has completely cooled off before starting the install.

2.4L ENGINE BLOCK HEATER INSTALL:

- Disconnect (do not remove) the air cleaner box.
- Position air cleaner hose out of the way.
- Locate core plug on the right (passenger's side) of engine.

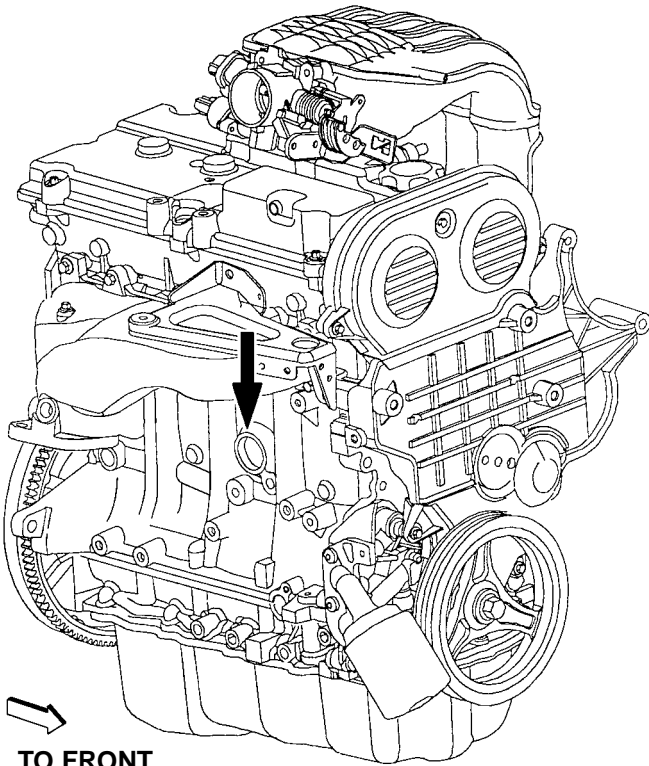

TO FRONT
OF VEHICLE

1

- Using a center punch and hammer, carefully strike the bottom edge of the core plug to break it loose.

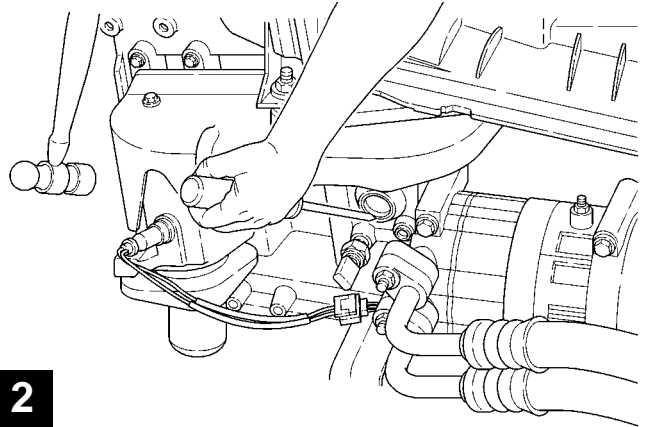

2

- Remove and discard the core plug.
- Clean the machined part of hole.

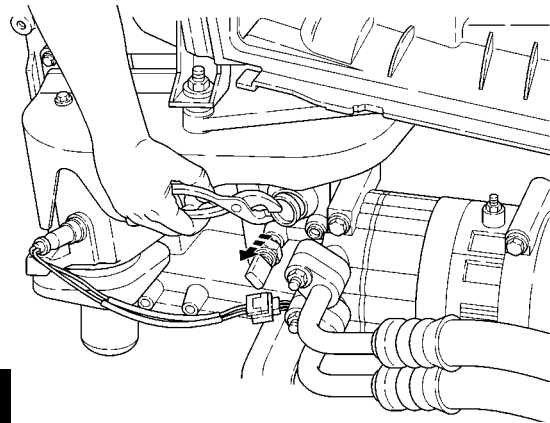

3

- Apply a coating of lubricant to the surface of hole and the "O" ring on the block heater.
- Insert block heater with element facing up. Push into block until fully seated.
- Using a flat blade screwdriver, tighten the center screw to 17 ± 3 in.-lbs. (1.9 N•m). (Do not overtighten.)

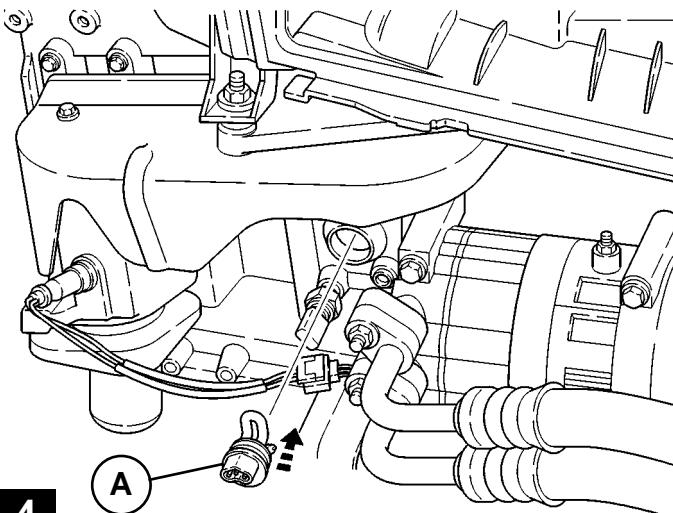

4

- Plug the cordset firmly into the block heater.

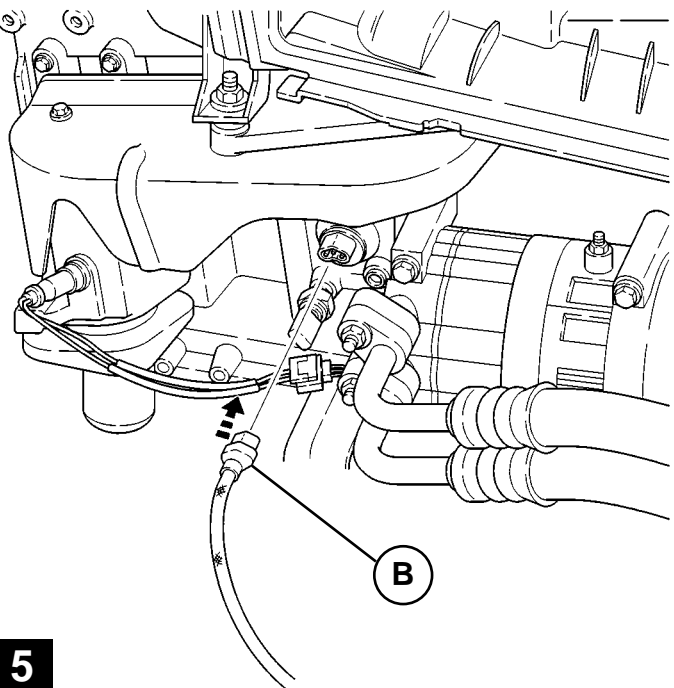

5

2.4L ENGINE CORDSET INSTALL:

- Route cordset upward and attach in-line push clip to hole in the air cleaner mounting bracket.
- CAUTION!** Make sure that cordset is positioned away from the exhaust manifold.

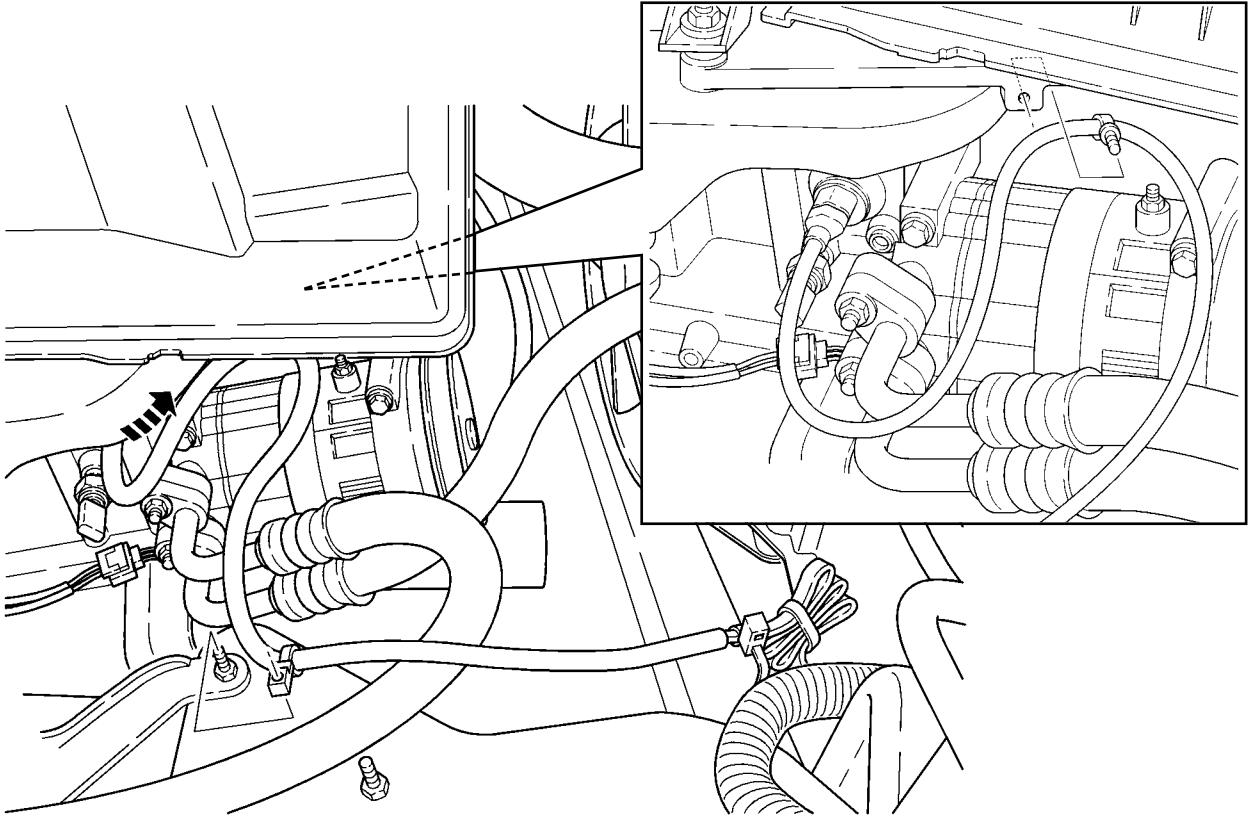

6

- Attach cordset in-line receptacle clip onto existing strut tower servo mounting stud.
- Route cordset forward and attach in-line tie strap to headlamp/cowl harness.
- Refill cooling system with the retained coolant. Start engine and check for leaks at the block heater.

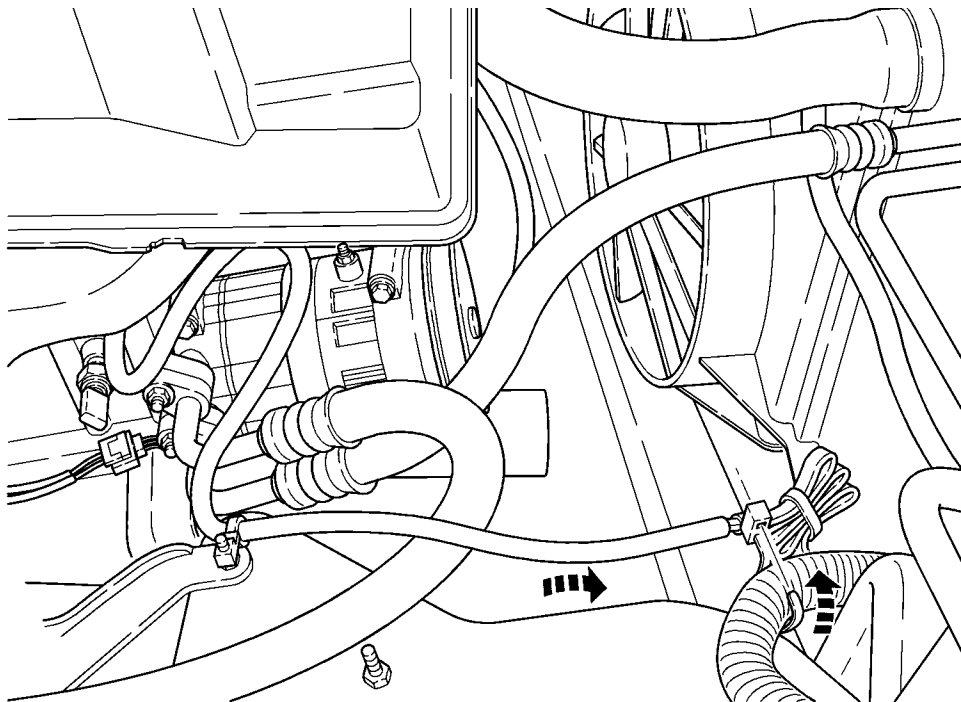

7

3.7L ENGINE BLOCK HEATER INSTALL:

- Raise and secure the vehicle on a lift.
- Locate core plug under the exhaust manifold and on the right (passenger's side) of engine.

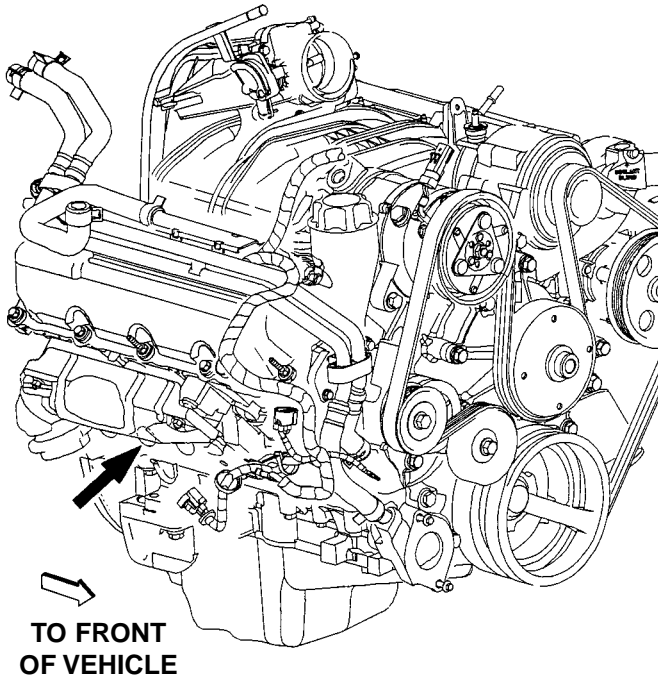

1

- Apply a coating of lubricant to the surface of hole and the "O" ring on the block heater
- Insert block heater with element facing up. Push into block until fully seated.
- Using a flat blade screwdriver, tighten the center screw to 17 ± 3 in.-lbs. (1.9 N•m). (**Do not overtighten.**)

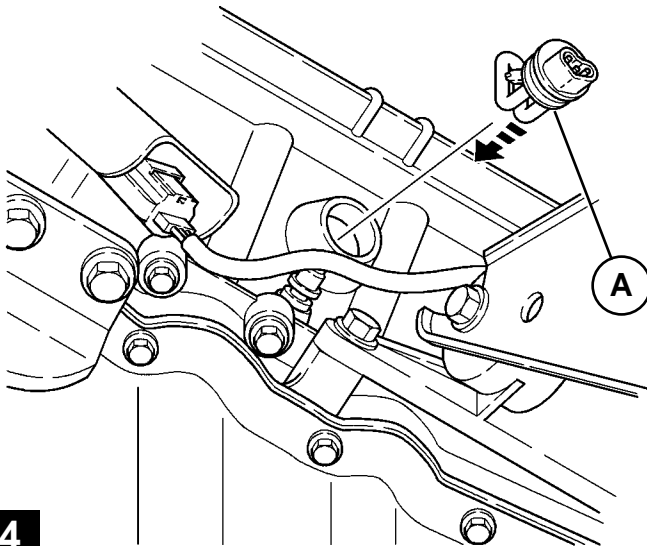

4

- Using a center punch and hammer, carefully strike the bottom edge of the core plug to break it loose.

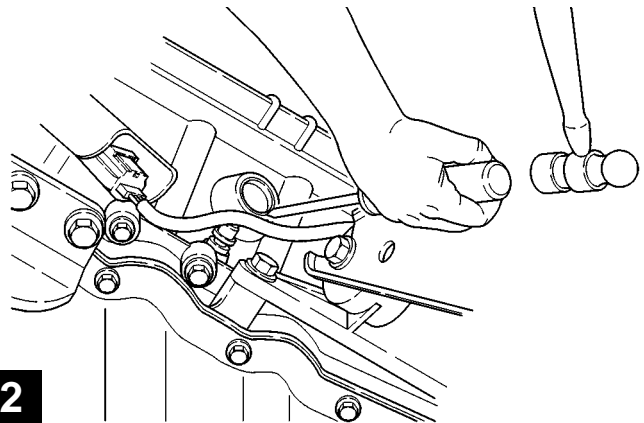

2

- Remove and discard the core plug.
- Clean the machined part of hole.

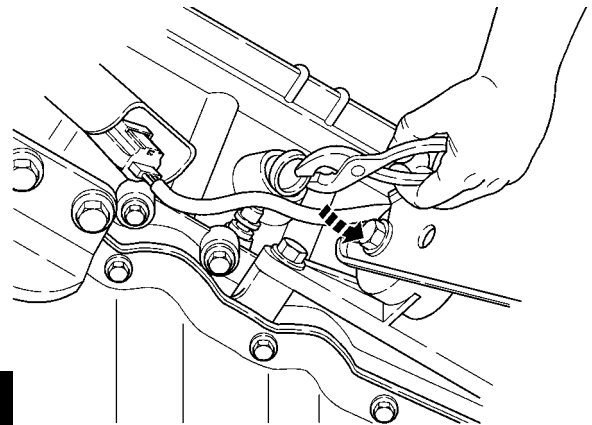

3

- Plug the cordset firmly into the block heater.

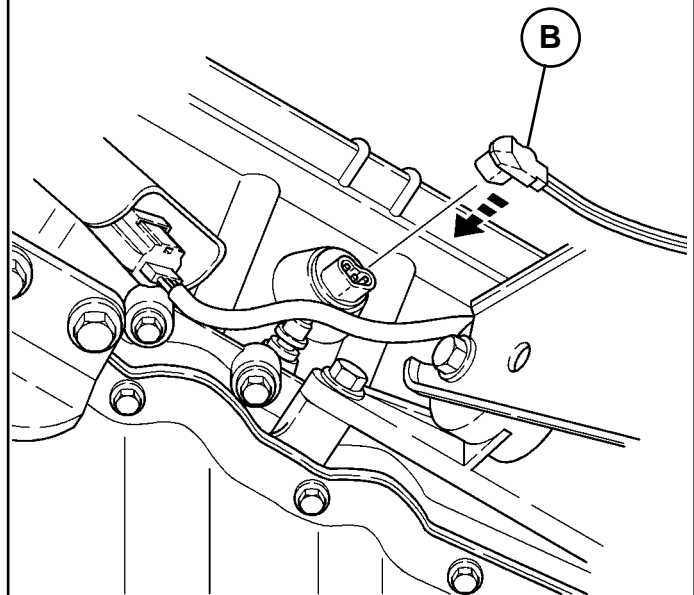

5

3.7L ENGINE CORDSET INSTALL:

- Lower the vehicle and open the hood.
- Route cordset upward along engine harness. Attach in-line tie strap to the harness.
- Attach cordset in-line receptacle clip onto frontmost valve cover stud.
- Route cordset rearward along the bottom of engine cooling hose. Attach in-line tie strap to the hose.
- Refill cooling system with the retained coolant. Start engine and check for leaks at the block heater.

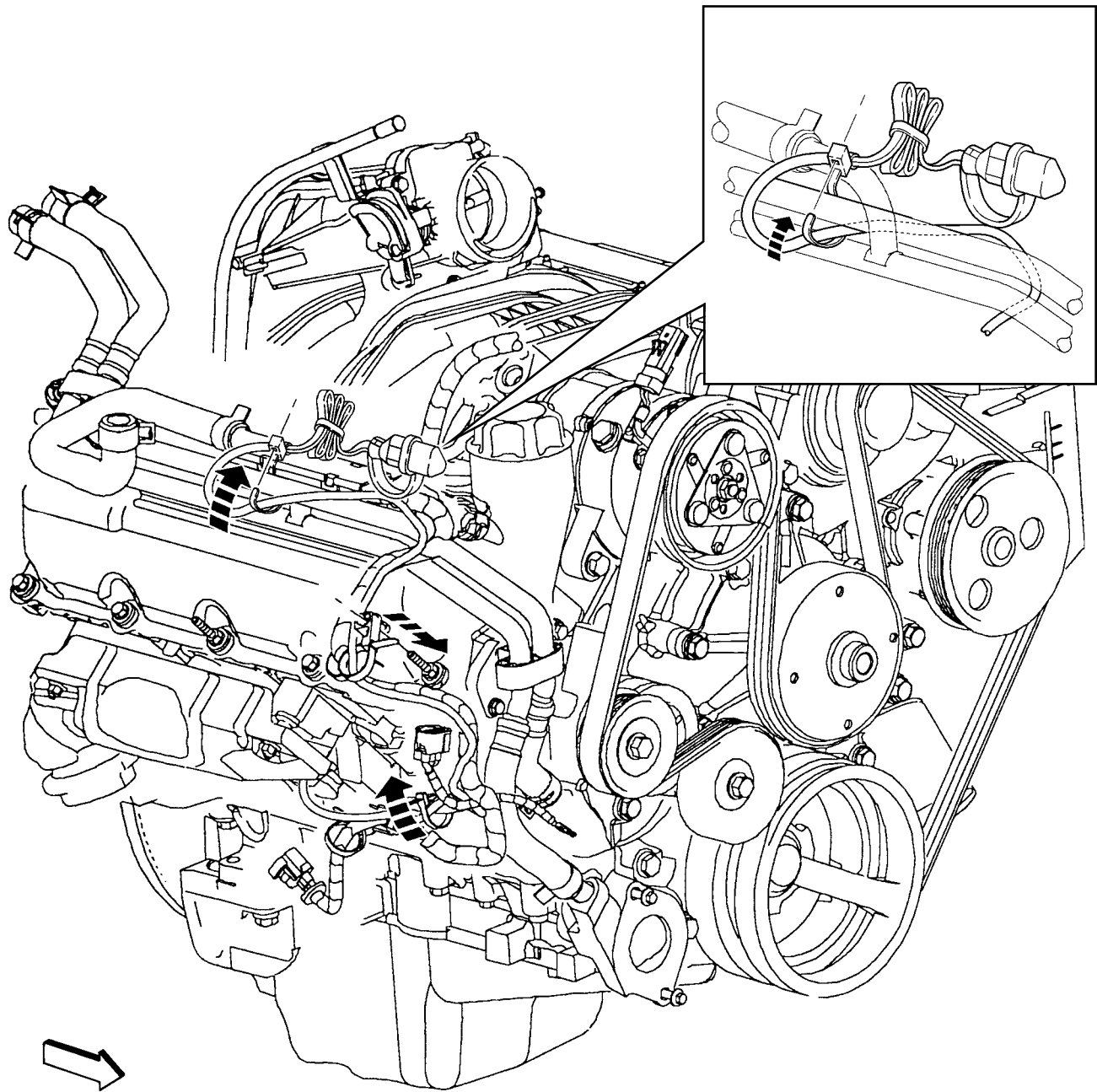

TO FRONT
OF VEHICLE