



# INSTALLATION INSTRUCTIONS     68531191AA

## Durango Pursuit – (CW7)

### Rear Door & Window Return to Standard kit

WD door lock/window Return to standard Kit			68531191AA
Location	Component	Part Number	Platinum Chrome
Left Hand	Inside Release Handle		68334953AA
	Inside Release Cable	same L/R	68092219AB
	Rear window switch		68085690AC
	Lock Rod		68375919AA
	Lock rod rubber bellow - slides over lock rod	Same L/R	<a href="#">68307302AA</a>
	Inside Handle Screw Cap		6CX24DX9AB
Right Hand	Inside Release Handle		68334952AA
	Inside Release Cable	Same L/R	68092219AB
	Rear window switch		68085690AC
	Lock Rod		68375918AA
	Lock rod rubber bellow - slides over lock rod	Same L/R	<a href="#">68307302AA</a>
	Inside Handle Screw Cap		6CX25DX9AB

## Removal

1. Disconnect and isolate the negative battery cable.
2. Remove the upper trim Remove the inner belt molding.
3. If necessary, temporarily connect the window switch assembly and battery to actuate the motor.
4. Position the glass to access the glass slider on the regulator through the access door (1).

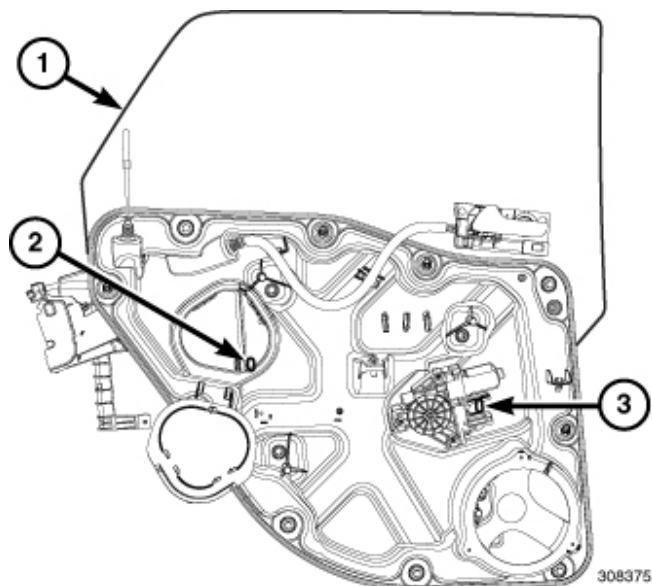



## INSTALLATION INSTRUCTIONS 68531191AA

### Durango Pursuit – (CW7) Rear Door & Window Return to Standard kit

5. Remove the plug (3) located near the motor.
6. Using the regulator, move the front door glass (1) up or down as required to access the two window regulator glass release tabs (2, 3) through the access holes in the regulator rails.

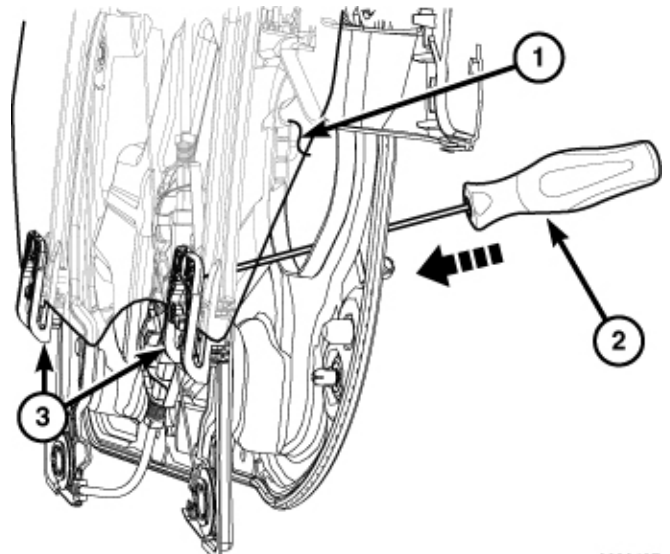

7. Through the access door release the regulator glass slider (1) and position the glass (3) in the full up position and secure the glass.

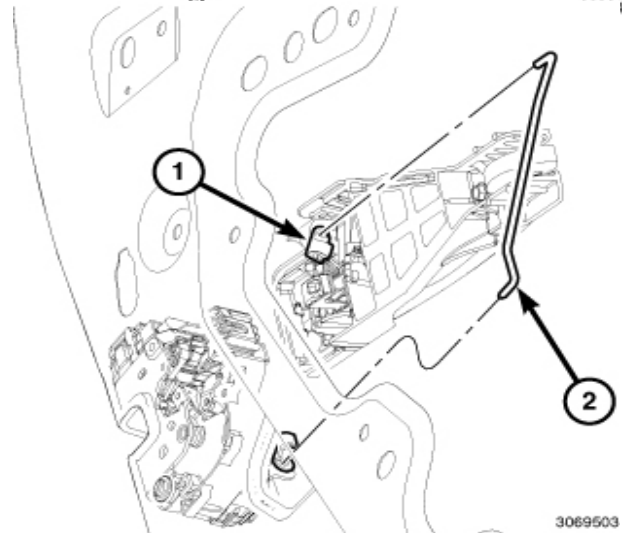

8. Remove the screws (3 and 4) securing the door latch to the door inner panel.

9. Release the clip (1) and disconnect the link (2) from the exterior handle.

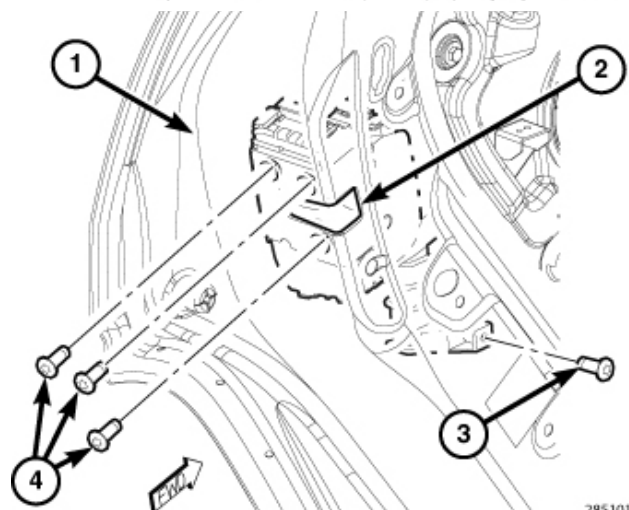



## INSTALLATION INSTRUCTIONS 68531191AA

### Durango Pursuit – (CW7) Rear Door & Window Return to Standard kit

## INSTALLATION

1. Position the latch (3) onto the door and connect the lock knob link (1) and the inside handle cable (2).
2. If removed, install the actuator links onto the rear door latch and engage the retainers. Slide the rubber bellow over the lock rod
3. Position the latch (1) over the mounting bracket.
4. Press down firmly and evenly to seat the retaining clips fully.
5. Install the door glass guide (5) with fastener (4) and tighten to the proper [Torque Specifications](#).

**CAUTION:** Verify wire harness is routed correctly to avoid contact with the door lock knob rod.

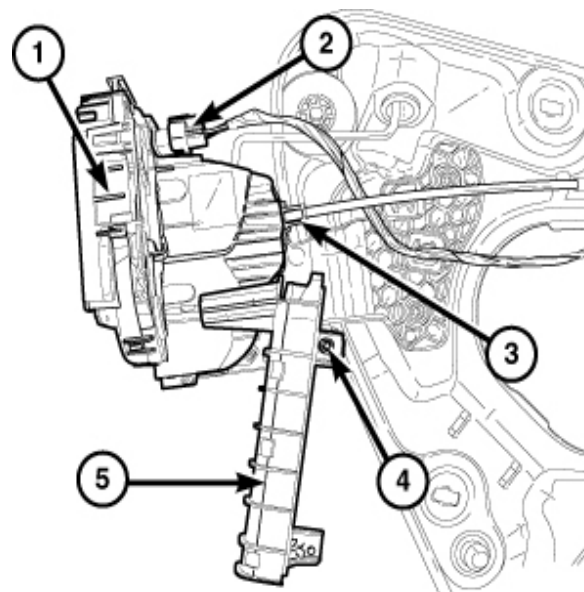
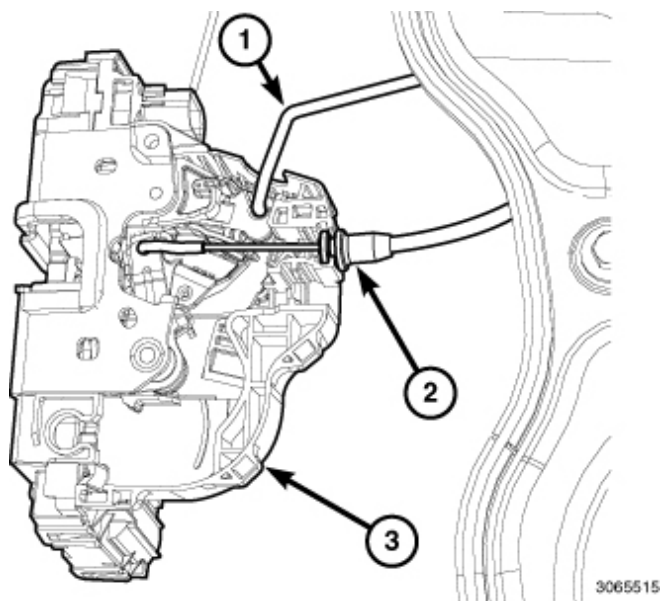



## INSTALLATION INSTRUCTIONS 68531191AA

### Durango Pursuit – (CW7) Rear Door & Window Return to Standard kit

6. Connect the door wire harness connector (2) to the rear door latch.

7. Position the rear door carrier (1) plate and install the fasteners (4) that secure the carrier plate to the door.

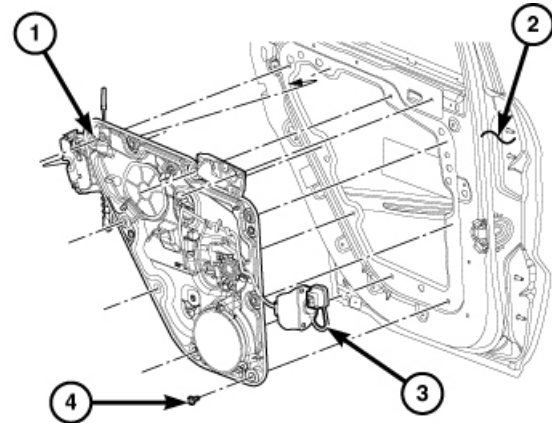

2850663

8. Twist the three retaining clips (1) counter clockwise and seat fully.

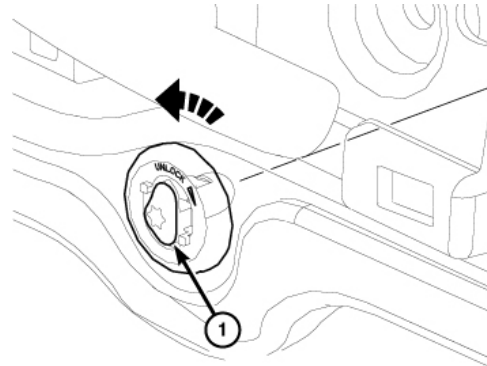

3063429

9. Carefully position the door seal (3) aside and route the harness under the seal.

10. Install and tighten the screws (4) securing the harness to the door.

11. Connect the negative battery cable.

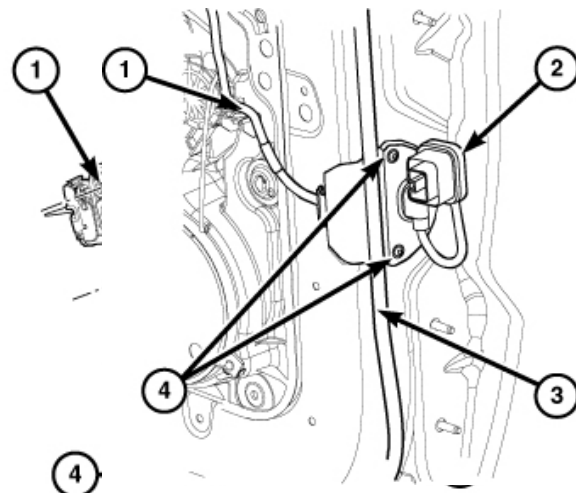

2851145

2850663



## INSTALLATION INSTRUCTIONS 68531191AA

### Durango Pursuit – (CW7) Rear Door & Window Return to Standard kit

12. connect the wire harness connectors.
13. Lift the rear trim panel (3) over the inside of the door far enough to engage the interior door latch lock link and knob into the hole (1) at the upper rear corner of the trim panel.
14. Position the inside door handle through the hole in the trim panel and align the trim panel over the locators.
15. Position the trim panel to the inside of the door and fully engage the new plastic door trim panel retention clips (3) to the door.
16. Install and tighten the screw (1) that secures the door trim panel to the door at the handle to the proper [Torque Specifications](#).  
1.
17. Install the latch fastener cover panel (2).

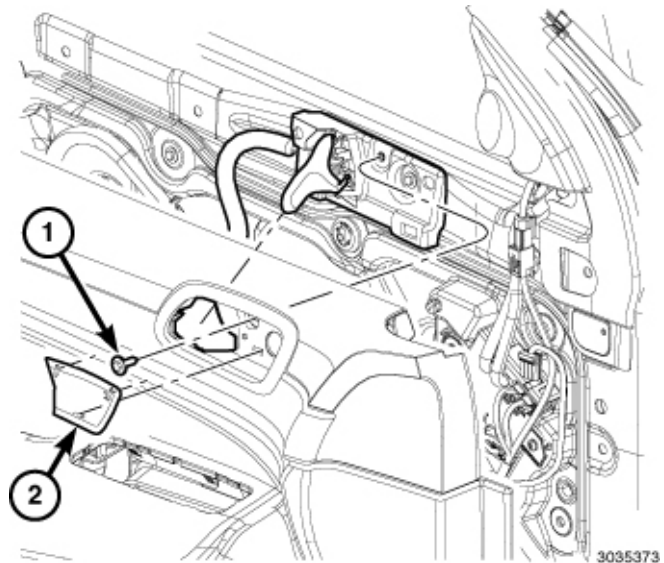



## INSTALLATION INSTRUCTIONS 68531191AA

### Durango Pursuit – (CW7) Rear Door & Window Return to Standard kit

18. Install the screw (5) at the armrest pull cup and tighten to the proper [Torque Specifications](#).
19. Install the trim cover (2) and seat fully.
20. Position the window switch (3), connect the door wiring harness connector (4) and press the switch assembly into place until the four clips engage.
21. Connect the negative battery cable.

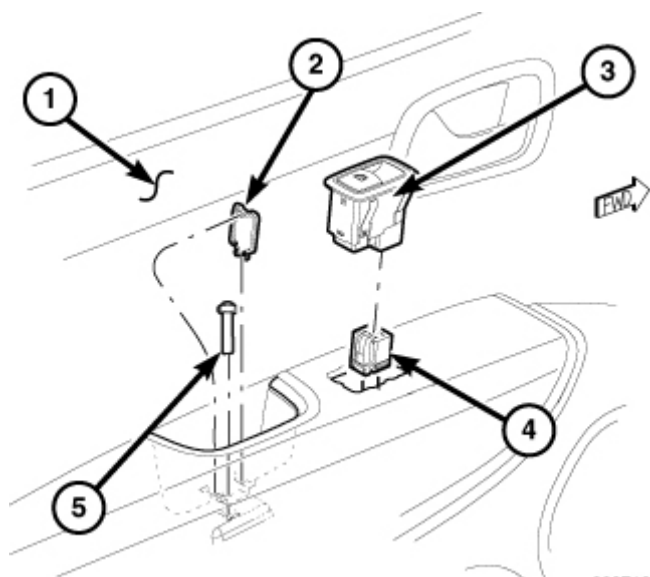

2827130

DESCRIPTION	N·m	Ft. Lbs	In. Lbs.
Rear Door Pull Cup Screw	2	—	18
Rear Door Regulator to Carrier Plate Screws	4	—	35
Rear Door Trim to Handle Screw	6	—	53